

GENERAL SPECIFICATIONS

• L.O.A	14,60 m	47'11"
• Hull length	14,27 m	46'10"
• L.W.L.	13,86 m	45'6"
• Beam	4,74 m	15'7"
• Deep draught	2,17 m	7'1"
• Deep ballast weight	3 550 kg	7,826 lbs
• Shallow draught	1,83 m	6'
• Shallow ballast weight	4 060 kg	8,951 lbs
• Air draught	21,69 m	71'2"
• Light displacement	12 594 kg	27,765 lbs
• Fuel capacity (standard)	200 l	53 US Gal
• Fuel capacity (Optional equipment)	200 l	53 US Gal
• Fresh water capacity (standard)	370 l	98 US Gal
• Fresh water capacity (Optional equipment)	320 l	85 US Gal
• Engine power	75 HP	75 HP
	POD 120	POD 120

ARCHITECT / DESIGNERS

- Naval Architect: Berret Racoupeau Yacht Design
- Interior design: Nauta Design

EC CERTIFICATE

- Category A - 11 persons
- Category B - 12 persons
- Category C - 14 persons

STANDARD SAIL LAYOUT AND AREA

• Mainsail (classic)	56,00 m ²	603 sq ft
• Genoa (105 %)	56,00 m ²	603 sq ft
• Asymmetrical spinnaker	130,00 m ²	1,400 sq ft
• I	18,75 m	61'6"
• J	6,06 m	19'11"
• P	17,09 m	56'1"
• E	5,55 m	18'3"

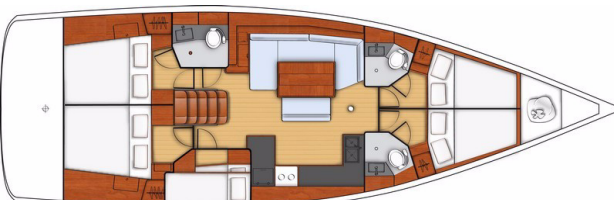
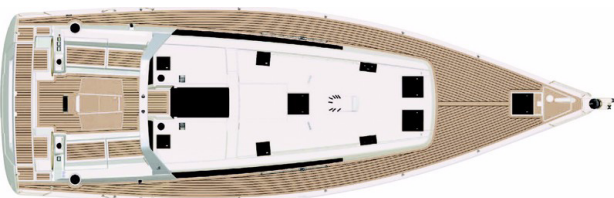

5 cabins - 3 head compartments





STANDARD EQUIPMENT

CONSTRUCTION

- Design in accordance with European Directive requirements and according to EC certification
- Monolithic hull design in polyester
- Monolithic structural inner moulding bonded to the hull
- Injection moulded deck in glass fibre/balsa sandwich, covered with «diamond-point» non-slip coating
- Deck hull joint screwed, bonded and banded with 1 solid wood bulwark
- Cast iron keel fixed with bolts and stainless steel backing plates
- Rudder hung with glass compound stock
- White coloured hull - Grey metal hull graphics

DECK EQUIPMENT

RIGGING

- Standard mast 9/10 anodized aluminium installed on the deck, 2 aft-swept spreaders
- Anodised aluminium boom
- Discontinuous stainless steel standing rigging
- 2 Backstays with bottlescrews
- Rigid boom vang with tackle
- Genoa furling system with drum on the deck
- 2 Blocks Stand Up on mainsheet arch
- 2 genoa tracks with piston adjusted traveller cars
- 2 Genoa sheet return blocks
- Rigging run back to cockpit (except boom topping lift)
- Complete running rigging: Main halyard, genoa halyard with clutch on mast and cleat, Boom topping lift with cleat on mast, Mainsheet, 2 Genoa sheets 2 rapid reefing lines, 1 manual reef
- 8 Jammers
- 2 halyard bags

WINCHES

- 2 Self-tailing genoa sheet winches (H60.2 STC)
- 2 Self tailing coachroof winches (H46.2 STC)
- 2 Aluminium winch handles Speed Grip
- 2 Winch handle boxes

SAILS

- Furling genoa with UV protective strip
- Semi full batten written sail with slider and roller slider
- System: Lazy Jack and Lazy Bag in Natural colour

MOORING LINES - MOORING

- Self-bailing chain locker - Clench bolt - Hatch cover
- Stainless steel bow fitting 2 rollers
- 12 V - 1500 W Vertical electrical windlass - Remote control
- 6 Aluminium mooring cleats - Stainless steel deck line protection

SAIL LOCKER

- Access through deck hatch T60
- Stainless steel ladder
- Shelving

SAFETY ON DECK

- 1 Open stainless steel forward pulpit
- 2 Stainless steel aft pushpits
- 1 Lifebuoy support bracket
- 1 Outboard engine bracket
- Ring for flag welded on balcony
- Double guardrail and stainless steel stanchions - Opening to port and to starboard in guardrail

COCKPIT

- Self-draining cockpit
- 2 Cockpit locker
- 2 Lockers in cockpit sole beneath helm's feet
- 1 Liferaft locker under helm seat
- 1 Gas locker for bottle(s) under the port helm seat
- Natural solid wood slatted cockpit benches
- 2 Steering wheel consoles: Stainless steel steering wheels - 900 mm diameter - leather covered - Steering gear at the helm station - metal cable transmission system - Stainless steel handrail - navigation instrument support (optional instruments) - Glass holder
- 1 Deck hole for access to tiller system + Power supply access hatch
- 1 Tiller
- 2 Steering compass on binacelle
- Portside engine control and control panel
- Polyester cockpit table - 2 flaps - oddments locker - central bottle holder - Stainless steel handrail - 12 V socket - lamp with shade
- Cold water cockpit shower hose
- 1 Fixed composite arch - Built-in lighting
- 1 Shore power socket to port
- 2 Hinged PMMA companionway doors - Sliding hatch made of PMMA

SWIM DECK / STERN DECK

- Fully opening transom, convertible to bathing platform (2,85 m x 0,77 m / 9'4" x 2'6")
- Electrically controlled opening
- Natural solid wood decking on sun deck
- 1 Stainless steel swim/boarding ladder - solid wood steps - folding

INTERIOR

- Woodwork Alpi Mahogany
- Parquet type laminated floors
- Fabric hull linings in saloon and cabins (White)
- Fabric upholstery
- Marine mattresses in the cabins

COMPANIONWAY

- Headroom: 1,98 m / 6'6"
- Wooden saloon companionway with moulded wood suspended steps with non-slip surface
- 2 Leather covered stainless steel handrails

SALOON

- Headroom: 1,98 m / 6'6"
- U shaped saloon bench - double density foam
- Locker seat with back rest on pantograph - with backrest
- Saloon table in 1 piece - Varnished wood top with inlay - Aluminium legs
- Mirror on bulkhead
- Cupboards - Shelves and stowage along the hull - Storage under bench seats
- Shelves with stainless steel fiddles
- 2 Panoramic deck house windows with concertina blinds
- 2 Hull portholes with curtain
- 2 Opening portholes on coaming in side windows
- 3 flush deck hatches with blinds / Mosquito net

CHART TABLE - PORT SIDE

- Table with flap - Moulded wood fiddle
- Switch panel on bulkhead for access to electrical functions
- 1 Reading light



GALLEY - PORT SIDE

- Headroom: 1,98 m / 6'6"
- U-shaped galley
- Compact grey laminated worktop
- 1 Stainless steel sink 2 rectangular basins - 1 Mixer tap with hot/cold water under pressure
- 1 Gas cooker 2 burners - Stainless steel oven on mountings - Stainless steel protection handrail
- 1 12 V 100 litre ice box / 26 US Gal, top opening
- 1 12 V 130 litre refrigerator / 34 US Gal, front opening
- Fitted lockers and closed shelving (Shelving, Bin)
- 1 Base cabinet: 1 Drawer - 2 shelves
- Storage space along the hull
- 2 Opening ports on coaming with curtains on side windows

2 SYMMETRICAL FORWARD CABINS

- Headroom: 1,92 m / 6'4"
- Central double bed (1,38 m x 0,75 m x 2,10 m / 4'6" x 2'6" x 6'11")
- Hanger closets - Cubby hole locker - Base cabinet
- 1 flush deck hatch with blind / Mosquito net
- 1 Hull porthole with curtain
- Access door for the washroom

2 FORWARD HEAD COMPARTMENT

- 2 symmetrical washrooms each with:
- Headroom: 1,92 m / 6'4"
 - Access through forward cabin
 - 1 Manual marine toilet
 - 1 Rigid holding tank 64L / 17 US Gal (optional)
 - Basin - Faucet
 - Shower hose
 - 1 Mirror
 - Toilet accessories
 - Stowage
 - 1 Opening deck hatch with blind / Mosquito net

2 AFT CABINS

- 2 Cabins each with:
- Headroom: 1,86 m / 6'1"
 - Double bed (1,55 m x 1,35 m x 2,05 m / 5'1" x 4'5" x 6'9")
 - Cupboard - Hanging locker - Stowage
 - Storage space along the full length of the bed
 - Access door for the washroom
 - 1 Large size hull port with curtain
 - 1 flush deck hatch with blind / Mosquito net
 - 1 Opening cockpit port with curtain
 - 1 Cockpit windows with curtains

PORT WASHROOM AFT

- 2 Cabins each with:
- Headroom: 1,92 m / 6'4"
 - Access via the cabin and the galley (for use as a toilet during the day)
 - Manual marine toilet
 - 1 Rigid holding tank 64L / 17 US Gal (optional)
 - Basin - Faucet
 - Shower hose
 - 1 Mirror
 - Toilet accessories
 - Stowage
 - 1 Opening deck hatch with blind / Mosquito net

Version 4 cabins - 4 head compartments

STARBOARD AFT HEAD COMPARTMENT

- Headroom: 1,92 m / 6'4"
- Access through saloon and the starboard aft cabin
- Separate shower - 1 Faucet - Stowage on bulkhead
- 1 Manual marine toilet
- 1 Rigid holding tank 64L / 17 US Gal
- Basin - 1 Faucet
- 2 Mirrors
- Toilet accessories
- 1 Opening portlight with curtains in side windows in the coaming

Version 5 cabins - 2 head compartments

STARBOARD SIDE CABIN

- Headroom: 1,92 m / 6'4"
- 2 Bunk beds: Top bunk (1,98 m x 0,76 m / 6'6" x 2'6") - Bottom bunk (1,98 m x 0,62 m / 6'6" x 2')
- Top bunk raises up to allow more space
- Storage
- 1 Opening porthole with curtain

Version 4 cabins - 3 head compartments

1 Head compartment to starboard for the aft cabins.
The galley is installed to port.
This configuration gives the advantage of a modulable chart table with two seats to port.
The saloon is opposite it to starboard.



ENGINE

- Engine Yanmar Diesel 75 hp / 75 HP Sail Drive or POD 120 Dock & Go
- Engine control - Control panel in the port cockpit
- Engine compartment: Soundproofing foam - Ventilation: 1 air intake and 1 pressured air outlet
- 1 Alternator 12 V / 125 Ah (Dock & Go: 1 Alternator 12 V / 120 Ah)
- 1 Rotomoulded diesel tank 200 L / 53 US Gal (under port aft berth) - Electronic gauge - Low level alarm - 1 Deck filler
- Filters: Sea water - Diesel - Decanter
- Fixed three blades propeller
- 1 Engine access through companionway (opening with 2 gas struts) - 2 Engine access through aft cabins

ELECTRICITY

- 12 V circuit
- 2 service batteries (140 Ah) - 1 Engine battery (110 Ah)
- 1 Power distributor
- 12 V Electrical panel (Fuses - Voltmeter - Water gauge - Fuel gauge - Battery warning - Fuel warning - Water warning)
- 1 12 V Sockets
- Lighting: Overhead lights - Reading lights
- Navigation lights: 1 Forward and aft navigation lights - 1 Engine navigation light / Spreader light forward of mast - 1 Anchor light on masthead
- Wire runs for options cables
- Full 220 V system (Interior sockets 220 V, 40 Amperes battery charger, Shore power socket)

PLUMBING

- 1 rotomoulded freshwater tank (330 l / 87 US Gal Forward cabin) - 1 Deck filler - Separate tank filling (if spare tank option) - Tank selection with ¼ by-pass valves
- Pressurised electric water pump - Expansion tank - Inline filter
- 40 L Electric water heater / 11 US Gal (engine run)
- 1 Rigid holding tank 64L / 17 US Gal
- Delayed shower draining and electric shower drain pumps
- 1 Electric bilge pump - 1 Manual bilge pump
- 1 Electric ice box drain pump

GAS

- 1 Gas bottle box in the cockpit (Diameter 0,34 m x 0,53 m / 1'1" x 1'9")
- Regulator and safety tap



TRIM LEVEL

	ESSENTIAL	EXCLUSIVE
• B&G Electronic: Helm consoles to port and starboard - 1 T41 Graphic display	■	■
• B&G Electronic: Sensor (Loch, Speedometer, Temperature)	■	■
• B&G Electronic: Wind Sensor (Windvane, Anemometer)	■	■
• Hot/cold water cockpit shower hose	■	■
• Hifi: Fusion + Interior loudspeakers & Waterproof exterior speakers	■	■
• LED interior lights	■	■
• 2 140 amperes additional service batteries + 1 40 Amperes battery charger additional	■	■
• 1 Port electric coachroof winch - H46.2 STAECH		■
• Galley: Top opening 12 V cool box in ice box (Freezer)		■
• Storage space(s) under the floor		■
• Saloon and Cabins: Indirect lighting LED		■
• Stainless steel beading for fenders in cockpit locker		■
• LED: Navigation lights		■

PACKS

ELECTRONIC B&G PACK

A Pack

- Steering consoles: 2 Zeus 7" wide multifonction touch screens (GPS, Chart plotter, Chart reader - Cartography Navionics Silver included)

B Pack

- Swivel base on reverse side of cockpit table
- Multifunction touchscreen B&G Zeus 12" wide(GPS, Chart plotter, Chart reader - Cartography Navionics Silver included)

PERFORMANCE PACK

- Performance Incidence Sails (D4)
- German system (Two-way mainsheet at the helm station)

DOCK & GO VERSION

- YANMAR Diesel Dock & Go POD 60 engine
- Swivel Saildrive base
- skyhook
- Vessel Management Unit (VMU)
- Bow thruster
- Auto pilot



OPTIONS

Navigation electronics: B&G

- Wifi interface
- 4G Radar
- AC 42 autopilot + Control at steering station
- Chart table: Zeus 7" wide additional multifunction screen
- Chart table: Fixed B&G+V50 VHF, function AIS receiver + H50 cockpit handset
- WR 10 Wireless autopilot remote control
- AIS 400
- Forward Scan Sensor (Underwater vision forward)

Rigging - Sails

- Anodized mast furling system with Dacron mainsail
- Asymmetrical spinnaker rigging + Code 0 Rigging
- Self-tacking jib hardware
- Asymmetrical spinnaker
- Code 0 on "Top Down" furling system
- Tacking jib (replacing genoa)
- self-tacking staysail with manual furling + Fixed forestay
- Additional bow roller - Stainless steel bobstay
- Releasable fore-stay chain-plate
- Backstays with bottlescrews (Adjustable)*
- Genoa sheet track leads adjustable from the cockpit
- 2 flag halyards

* *Except on mast with in-mast furling*

Winches

- 2 Electric genoa sheet winches H 60.2 STCEH

Hull - Deck - Cockpit

- Grey "Perle" hull
- Blue-grey hull
- Cockpit sole natural solid wood
- Solid wood slatted catwalks
- Polyester/wood cockpit table + White PVC protective covers
- Silver Coachroof sprayhood
- Silver Cockpit Bimini
- Luxe coachroof , Cadet Grey
- Bimini top Luxe, Cadet Grey
- Complete cockpit closing Luxe, Cadet Grey
- White PVC steering wheel covers
- Cases pack Luxe (Table + Steering consoles), Cadet Grey
- Dark Narval Cockpit cushions + Carbon Sky backrests
- Bow thruster
- Refrigerated ice-box in cockpit table (30 L / 8 US Gal) - Positive cold
- 3 retractable blades propeller
- Stainless steel arch with davits
- White composite steering wheels
- Moorings lines, Mooring, Fenders
- Mooring cleats (stern deck)
- Windlass control in cockpit with chain counter
- Gangway ladders
- 4 Underwater projectors
- Shore freshwater supply
- Windex Windvane

Interior equipment

- Interior woodwork: Alpi matt light oak
 - Luxe folding saloon table (double berth compatible)
 - Interior upholstery, according to swatches: Fabrics, Leather, Ultraleather
 - Upholstery padding (Saloon and Cabins): Anthracite Grey or Taupe lacquered
 - TV LCD 24" + DVD player in the saloon
 - Stainless steel 3 burner oven/grill cooker on Luxe mounting
 - 220V Microwave oven
 - Dishwasher
 - Sandblasted finish shower screen, Forward cabin (In place of standard)
 - Double berth in saloon
 - Slat mattresses
 - Additional holding tank
 - Quiet Flush electric toilet
 - Mosquito nets
 - Galley: Sea water/fresh water foot pump
 - Extra water tank (2 x 160 l / 2 x 42 US Gal)
 - Additional diesel tank (200 l / 2 x 53 US Gal)
-
- 12/220 V, 2 kVA converter
 - 6 KVA 220 V / 50 Hz Generator - with cocoon
 - Forced air heating fuel
 - 220 V / 50 Hz Air conditioning
 - Water maker 60 l/h (16 US Gal/h)